

UNDERSINK/SULLAGE CHAMBER ALARM

FPC-12674 - VALVE SHUT-OFF WITH DRIP TRAY MOISTURE SENSOR ROPE



HARDWARE FEATURES

Enclosure:

- IP54 weatherproof rating
- Polycarbonate
- Mounting brackets included

Protection:

- Low voltage control and input circuitry
- No hard wiring needed

Alarms:

- Audible (buzzer) alarm

Control & interface:

- Electronic Keypad
- Indicator lights for power on and level alarm
- Audible alarm mute/reset/test button

Inputs:

- Digital 12Vdc input for moisture sensing rope

Outputs:

- 12Vdc output for solenoid valve
- BMS volt free output for common fault

Included with panel:

- 10 Amp 3 pin 1.5m power supply lead
- 20mm male/male 12Vdc pulse latching solenoid valve (pre-connected)
- 5 mtr moisture sensing rope (pre-connected)

FUNCTION FEATURES

- In the event of fluid detected in the drip tray, the controller activates the alarm, pulse closes the valve, ensuring no further mains water enters the sink and chamber, ensuring no further 'inflow' to the chamber occurs
- If power to the controller is switched off, the valve is immediately closed

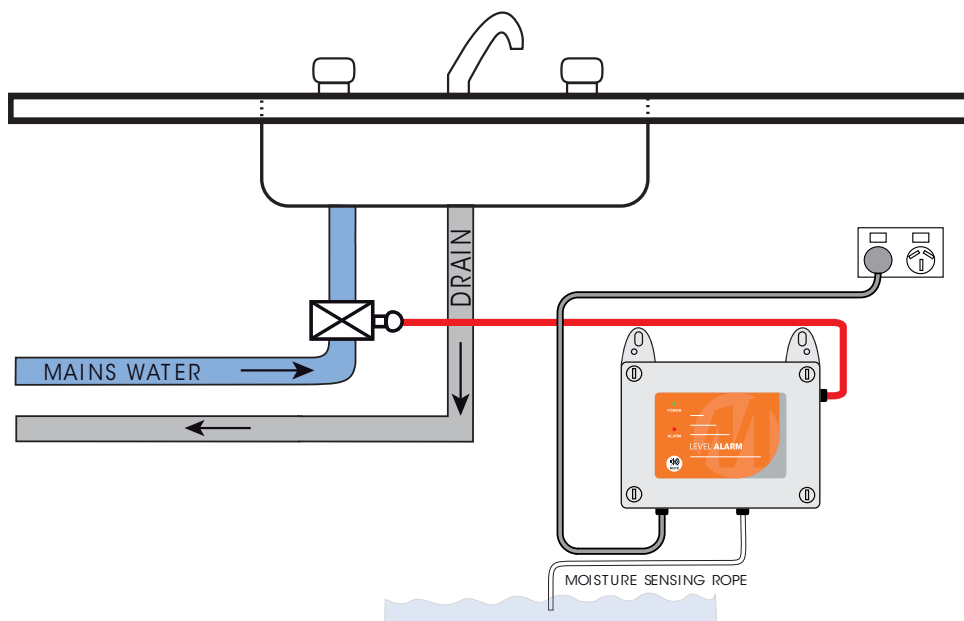

SINGLE PHASE (230VAC)

Code	Description	Enclosure Size
FPC-12674	Undersink/Sullage Chamber Alarm - Valve Shut-Off with Drip Tray Moisture Sensor	200x160x95mm