

## SINGLE/DUAL PUMP INTERFACE - FPC-30120

MATElec Australia's SMS Alarm/Status Communicator features the newly designed ME-Link Module, which is a cellular CAT-M1 remote monitoring and control device utilising the 700Mhz frequency for 'best in class' signal strength. The Single/Dual Pump Interface Version of the Communicator reports status information and alarms from the BMS/remote output on MATElec Australia Standard Single and Dual Pump Controllers. The ME-Link Module can also be utilised to control external devices with the two onboard relay outputs, and uses easy to set up SMS commands to configure the operation and alarms without the need for any additional software.

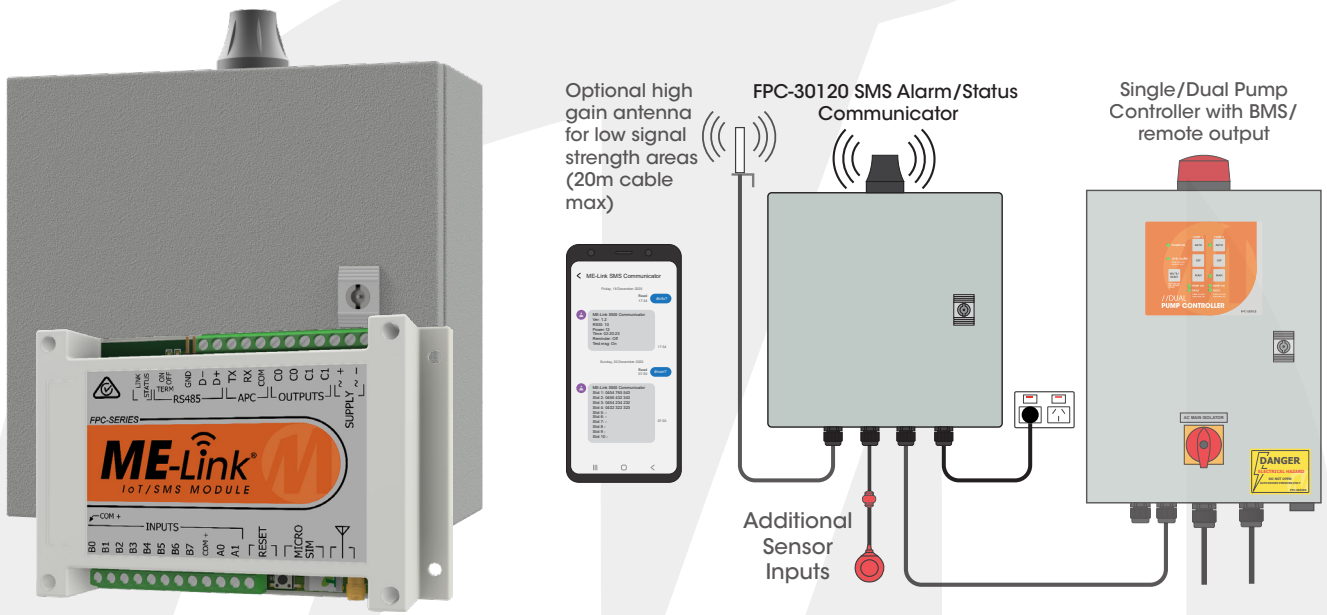

ME-Link IoT/SMS Module

### HARDWARE FEATURES

#### Enclosure:

- IP54 rated, powder coated mild steel enclosure with removable gland plate

#### Protection:

- Low voltage control and input circuitry
- Din rail mounted input terminal connections

#### Control & interface:

- ME-Link IoT/SMS module (requires micro SIM card from network provider with CAT-M1 enabled)
- Vandal resistant antenna (remote mount high gain antenna also available for low signal strength areas)
- BMS interface board for ME-Link to Pump Controller interface
- Battery backup for mains power failure

#### Inputs:

- Single phase (230Vac) power supply
- Input for connection to BMS/remote output on a MATElec Standard Single or Dual Pump Controller
- 2x Digital 12Vdc inputs for sensors on ME-Link module

#### Outputs:

- 2x Relay outputs on ME-Link module

#### Included with panel:

- 10 Amp 3 pin 1.5m power supply lead

### FUNCTION FEATURES

- SMS messaging for high level and pump faults from the pump controller, power/battery supply status and from up to 2 additional digital inputs
- Easy programming with SMS commands
- Up to 10 phone numbers can receive messages
- Smart help responses on incorrect commands
- Once, repeat or sequential notification messaging
- Repeat or sequential messaging until user accepted
- Daily reminder messages for active alarms
- Remote control of systems and or devices via the 2 relay outputs
- Periodic test messages to ensure ME-Link is connected and operating
- Temporary disabling of notifications for site servicing
- Logged data for 'last alarm', 'acknowledgement time and number'

Micro SIM card required from network provider with CAT-M1 enabled (currently only Telstra has CAT-M1 enabled)



15mm

12mm

### SMS ALARM/STATUS COMMUNICATOR - SINGLE/DUAL PUMP INTERFACE

Code	Description	Enclosure Size
FPC-30120	SMS Alarm/Status Communicator - Single/Dual Pump Interface	300x300x150mm

P: 1800 281 282 | F: 1300 281 282 | E: info@matelecaustralia.com.au | W: www.matelecaustralia.com.au